

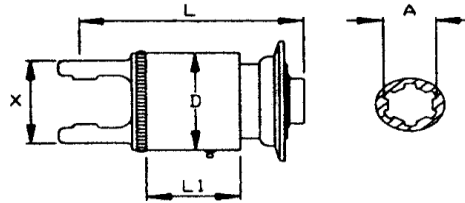

Overrunning Clutch with QD Lock, Ball Type

Right Hand Rotation



Shaft Size		D	X	L	L1	A	Torque	Part No.
Series 1	22 X 54	91	73	149	54	1-3/8"-6 1-3/8"-21	3,000	8-R2L0138RD 8-R2L0121RD
Series 2	23.8 X 61.3		73	149		1-3/8"-6 1-3/8"-21		8-R2L0238RD 8-R2L0221RD
Series 3 *	27 X 70		86	154		1-3/8"-6 1-3/8"-21		8-R2B0338RD 8-R2B0321RD
Series 4	27 X 74.6		86	154		1-3/8"-6 1-3/8"-21		8-R2L0438RD 8-R2L0421RD
Series 5	30.2 X 80		93	157		1-3/8"-6 1-3/8"-21		8-R2B0538RD 8-R2B0521RD
Series 6	30.2 x 92		106	167		1-3/8"-6 1-3/8"-21		8-R2B0638RD 8-R2B0621RD
Series 7	35 x 94		106	167		1-3/8"-6 1-3/8"-21		8-R2B0738RD 8-R2B0721RD
Series 8	35 x 106.5		117	184		1-3/8"-6 1-3/8"-21		8-R2B0838RD 8-R2B0821RD

Overrunning clutch available for left hand rotation - series RRSB-RS

* Type phase out

Right Hand Rotation

	RM2
	L=174
Part No.	8-RM238RD

